

**7A A14100701A**  
CAP ASM

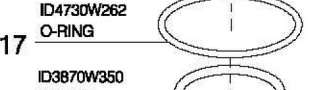

**C 28/50 P1**

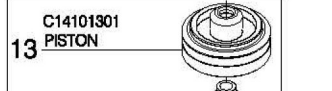
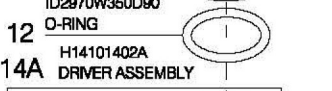
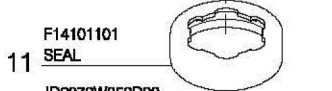
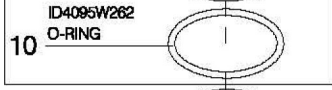
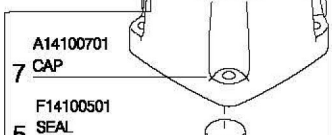
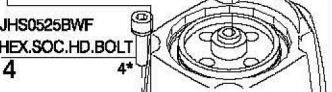
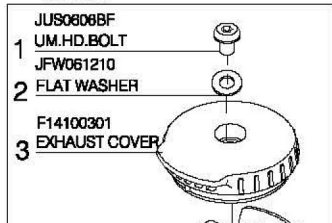
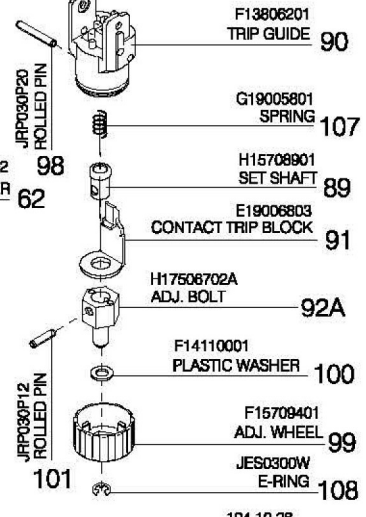
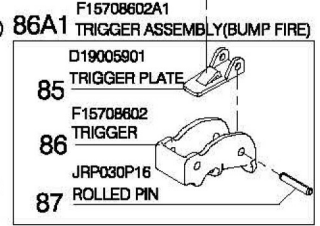
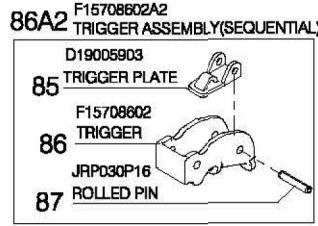
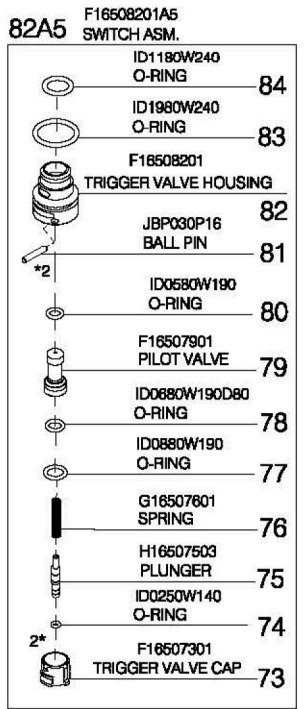
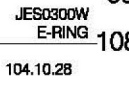
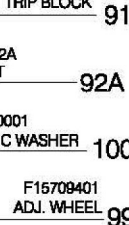
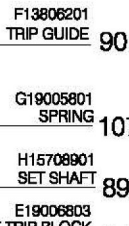
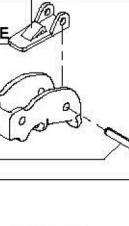
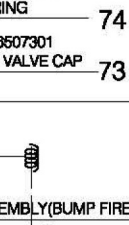
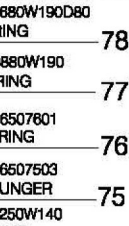
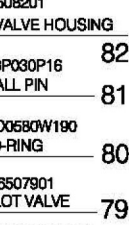
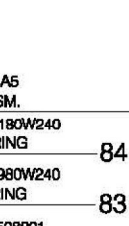
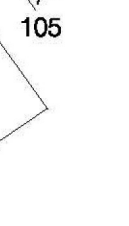
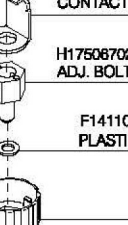
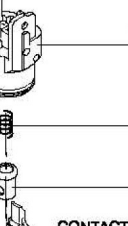
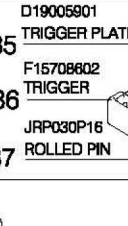
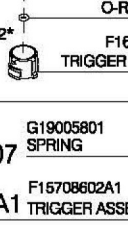
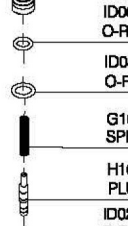
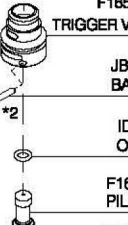
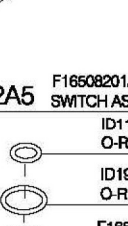
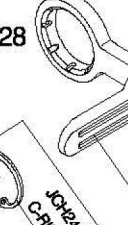
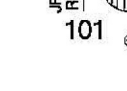
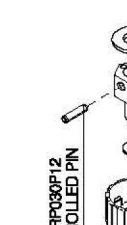
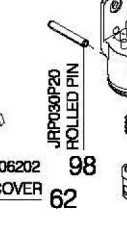
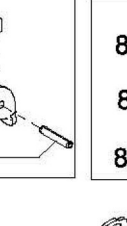
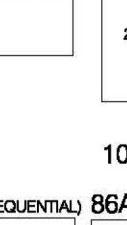
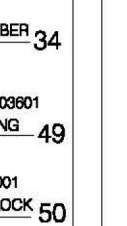
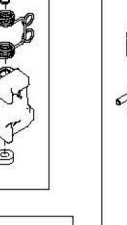
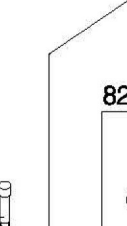
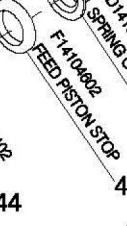
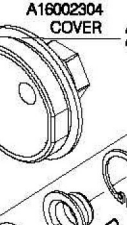
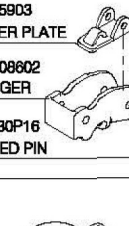
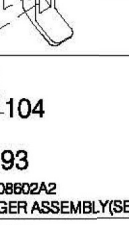
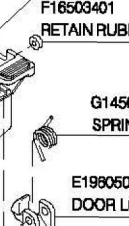
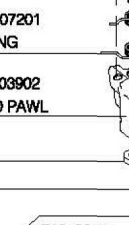
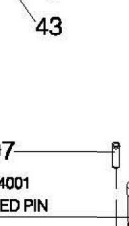
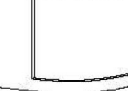
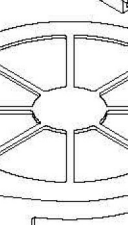
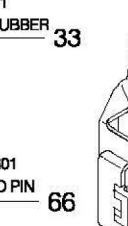
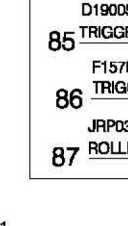
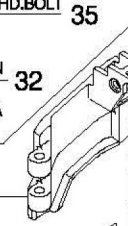
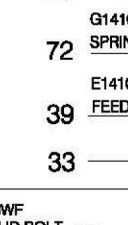
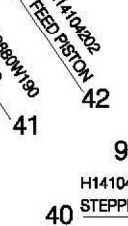
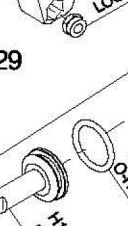
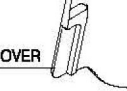
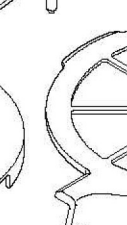
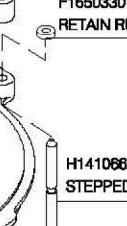
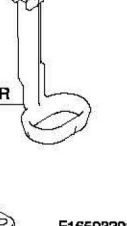
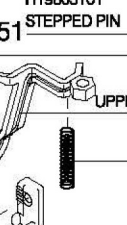
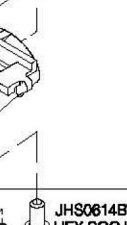
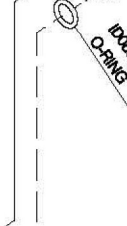
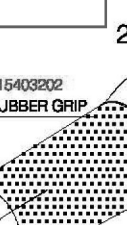
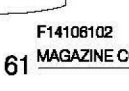
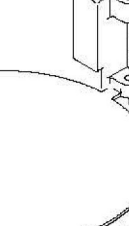
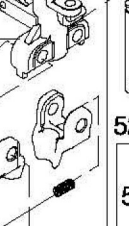
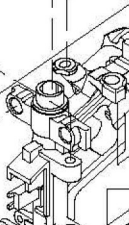
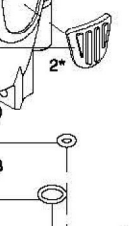
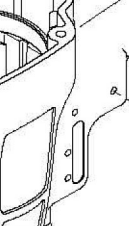
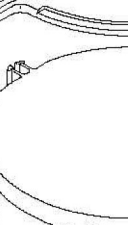
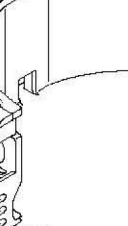
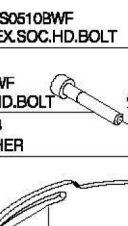
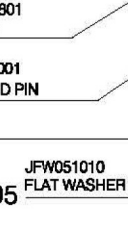
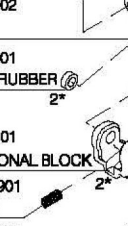
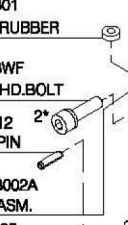
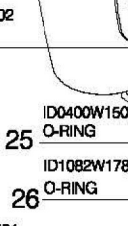
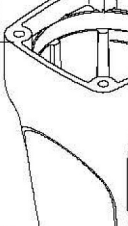
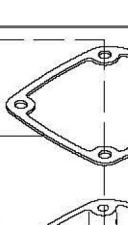
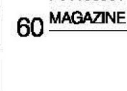
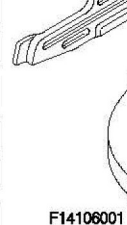
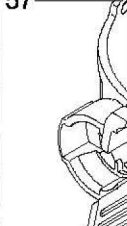
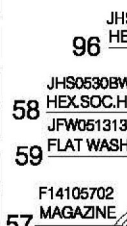
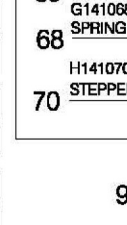
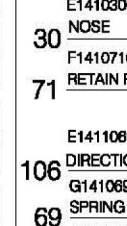
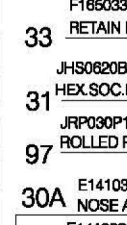
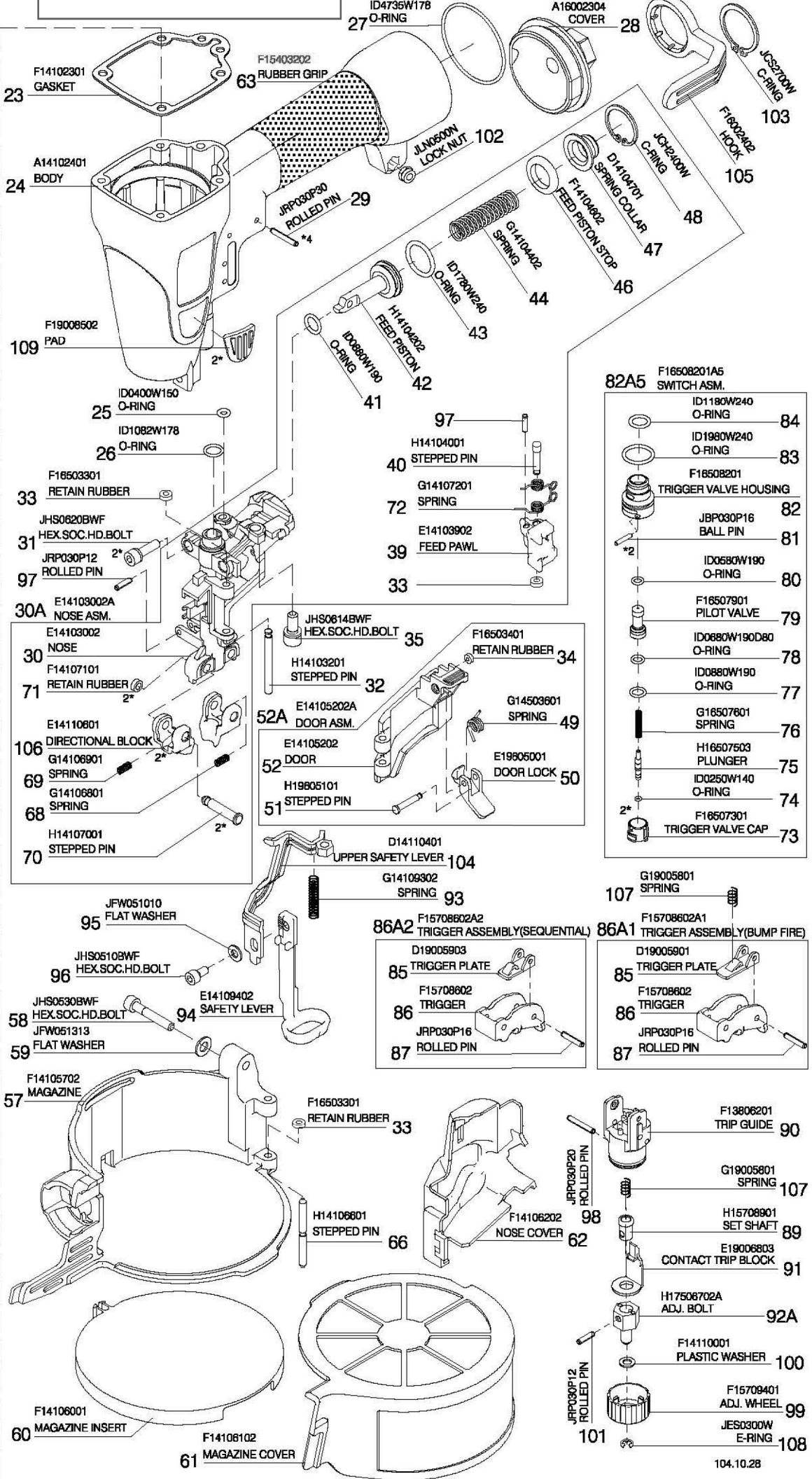

MARKS & NOS	Description	
7A	A14100701A	CAP ASM.
1	JUS0606BF	UM.HD.BOLT
2	JFW061210	FLAT WASHER
3	F14100301	EXHAUST COVER
4	JHS0525BWF	HEX.SOC.HD.BOLT
7	A14100701	CAP
5	F14100501	SEAL
8	F14100801	PISTON STOPPER
6	G14100601	SPRING
9	F14100901	PISTON HEAD VALVE
10	ID4095W262	O-RING
11	F14101101	SEAL
12	ID2970W350D90	O-RING
14A	H14101402A	DRIVER ASSEMBLY
15	C14101501	CYLINDER
20	ID3777W262	O-RING
16	F14101601	COLLAR
17	ID4730W262	O-RING
18	ID3870W350	O-RING
19	F14101901	BUMPER
23	F14102301	GASKET
24	A14102401	BODY
109	F19008502	PAD
25	ID0400W150	O-RING
26	ID1082W178	O-RING
33	F16503301	RETAIN RUBBER
31	JHS0620BWF	HEX.SOC.HD.BOLT
97	JRP030P12	ROLLED PIN
30A	E14103002A	NOSE ASM.
30	E14103002	NOSE
71	F14107101	RETAIN RUBBER
106	E14110601	DIRECTIONAL BLOCK
69	G14106901	SPRING
68	G14106801	SPRING
70	H14107001	STEPPED PIN
95	JFW051010	FLAT WASHER
96	JHS0510BWF	HEX.SOC.HD.BOLT
58	JHS0530BWF	HEX.SOC.HD.BOLT
59	JFW051313	FLAT WASHER
57	F14105702	MAGAZINE
94	E14109402	SAFETY LEVER
60	F14106001	MAGAZINE INSERT
63	F15403202	RUBBER GRIP
27	ID4735W178	O-RING
28	A16002304	COVER
102	JLN0500N	LOCK NUT
29	JRP030P30	ROLLED PIN

MARKS & NOS	Description	
103	JCS2700W	C-RING
105	F16002402	HOOK
48	JCH2400W	C-RING
47	D14104701	SPRING COLLAR
46	F14104602	FEED PISTON STOP
44	G14104402	SPRING
43	ID1780W240	O-RING
42	H14104202	FEED PISTON
41	ID0880W190	O-RING
40	H14104001	STEPPED PIN
72	G14107201	SPRING
39	E14103902	FEED PAWL
35	JHS0614BWF	HEX.SOC.HD.BOLT
32	H14103201	STEPPED PIN
52A	E14105202A	DOOR ASM.
52	E14105202	DOOR
51	H19605101	STEPPED PIN
34	F16503401	RETAIN RUBBER
49	G14503601	SPRING
50	E19605001	DOOR LOCK
104	D14110401	UPPER SAFETY LEVER
93	G14109302	SPRING
86A2	F15708602A2	TRIGGER ASSEMBLY
86A1	F15708602A1	TRIGGER ASSEMBLY
33	F16503301	RETAIN RUBBER
66	H14106601	STEPPED PIN
61	F14106102	MAGAZINE COVER
82A5	F16508201A5	SWITCH ASM.
107	G19005801	SPRING
90	F13806201	TRIP GUIDE
107	G19005801	SPRING
89	H15708901	SET SHAFT
91	E19006803	CONTACT TRIP BLOCK
92A	H17506702A	ADJ. BOLT
100	F14110001	PLASTIC WASHER
99	F15709401	ADJ. WHEEL
108	JES0300W	E-RING
101	JRP030P12	ROLLED PIN
98	JRP030P20	ROLLED PIN
62	F14106202	NOSE COVER